



## Driwall™ Prefabricated Composite Drain Products

Driwall™ Prefabricated Composite Drain products are drainage mats designed to eliminate hydrostatic pressure from behind foundation walls, retaining walls, planters, plaza decks, and balconies.

A filter fabric is heat-laminated to one side of the mat to hold soil or concrete away from the wall or deck and keep the drainage plane clear. When using Driwall™ Prefabricated Composite Drain, aggregate for drainage can be eliminated from the construction site.

### Benefits

- ✓ Fire resistant – Class A fire rated product
- ✓ Minimal deflection, and no creep or long-term degradation
- ✓ Provides a thin profile for tight construction assemblies
- ✓ Lightweight and easy to handle



*Driwall™ Prefabricated Composite Drain is 0.125 - 0.40 inches thick (3.175 - 10.0 mm)*

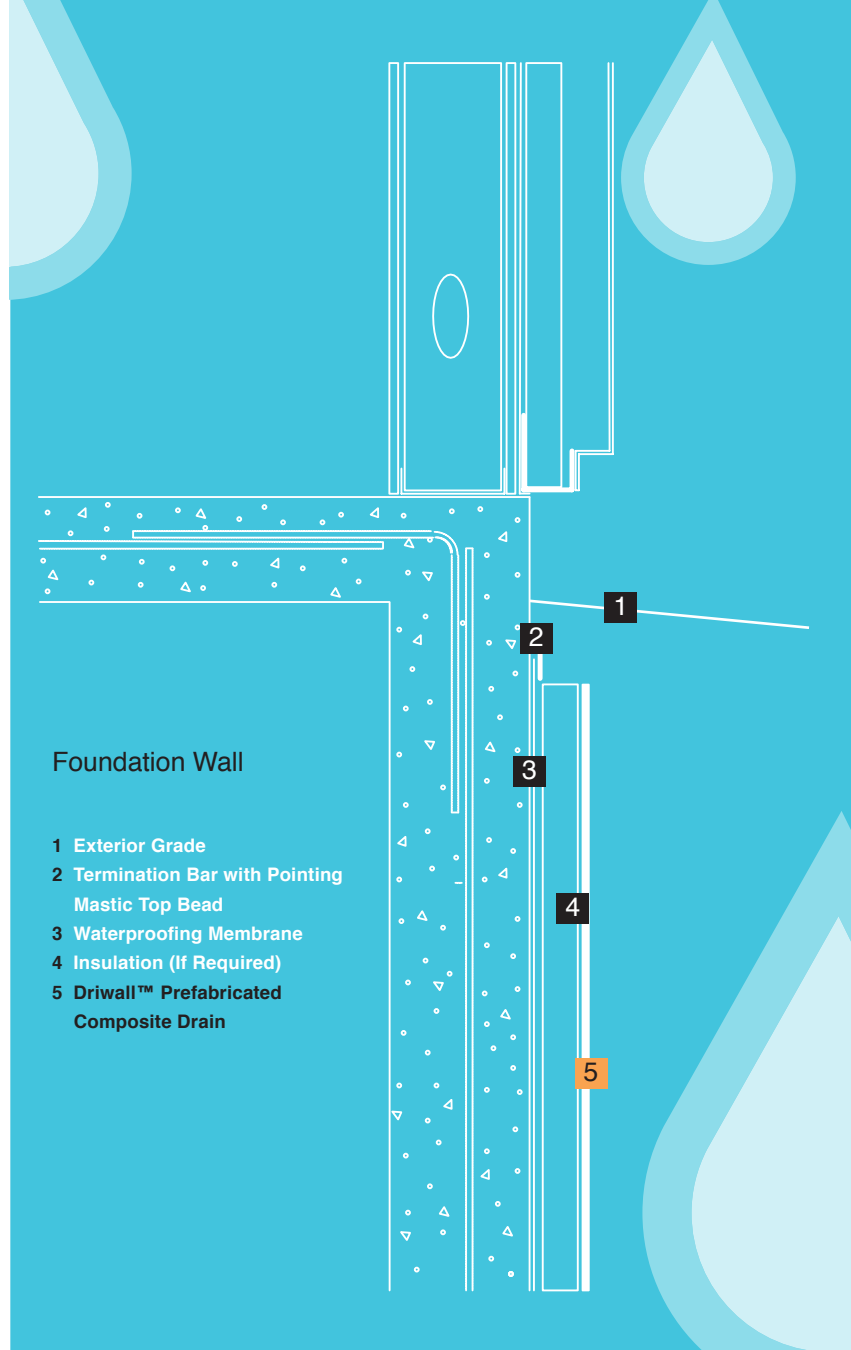

Foundation Wall

- 1 Exterior Grade
- 2 Termination Bar with Pointing Mastic Top Bead
- 3 Waterproofing Membrane
- 4 Insulation (If Required)
- 5 Driwall™ Prefabricated Composite Drain





## Driwall™ Prefabricated Composite Drain (PCD)

Product	Thickness	Length	Area	Roll Dimension	Roll Weight
Driwall PCD 10/013	0.125 in./3.175 mm	100 ft.	400 sq. ft.	18 x 18 x 48 in.	30 lbs.
Driwall PCD 10/025	0.25 in./6.0 mm	100 ft.	400 sq. ft.	22 x 22 x 48 in.	53 lbs.
Driwall PCD 10/025-2 MEM	0.33 in./8.0 mm	75 ft.	300 sq. ft.	29 x 29 x 48 in.	52 lbs.
Driwall PCD 10/040	0.40 in./10.0 mm	100 ft.	400 sq. ft.	24 x 24 x 48 in.	56 lbs.
Driwall PCD 10/045	0.40 in./10.0 mm	100 ft.	400 sq. ft.	24 x 24 x 48 in.	55.6 lbs.
Driwall PCD 10/045-2	0.40 in./10.0 mm	100 ft.	400 sq. ft.	35 x 35 x 48 in.	62.2 lbs.
Driwall PCD 10/046	0.40 in./10.0 mm	100 ft.	400 sq. ft.	24 x 24 x 48 in.	55.6 lbs.

For a complete list of all our products, please contact KBP, or visit our website at [www.KeeneBuilding.com](http://www.KeeneBuilding.com)

### Applications

- ✓ Plazas, foundation walls, and planters
- ✓ Balconies
- ✓ Bored rock tunnels with moisture flow
- ✓ Will protect soft membranes
- ✓ Green roofs

### Foundation Wall Base Perimeter Drain

- 1 Waterproofing Membrane
- 2 Foundation Insulation (If Required)
- 3 Driwall™ Prefabricated Composite Drain
- 4 Drain Tile System (Drained to Daylight or a Collection and Ejection System)
- 5 Free-Draining Gravel Wrapped in Filter Fabric
- 6 Under Slab Insulation (If Required)

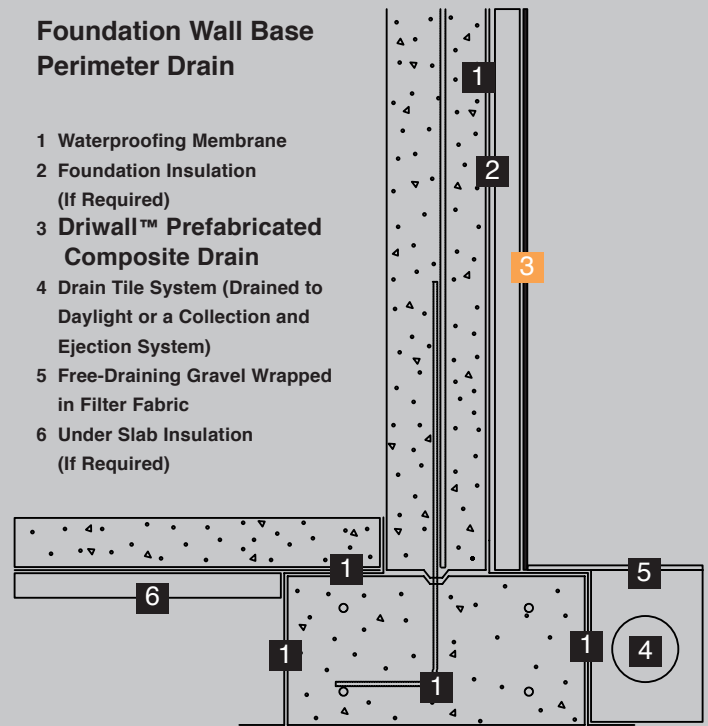

P.O. Box 241353

Mayfield Heights, OH 44124

[Info@KeeneBuilding.com](mailto:Info@KeeneBuilding.com)

[KeeneBuilding.com](http://KeeneBuilding.com)

877 | 514 | 5336

P 440 | 605 | 1020

F 440 | 605 | 1120